

Board breakthrough

Innovative waterblocking technology will make CeminSeal™ Wallboard more secure and easier to install.

In a world first, Cemintel™ Fibre Cement Systems has developed a new waterblocking technology that reduces water absorption into the sheet, keeping it stronger and more stable.

The new technology is embedded into the CeminSeal™ Wallboard sheets, ensuring stronger joints and less risk.

The new patented technology will be applied across a family of manufactured products, CeminSeal™ Wallboard being the first product launched in the range. The new board is hydrophobic and vapour permeable, meaning it repels water while still allowing the sheet to breathe. The waterblocking technology makes the sheet more stable and easier to cut.

Drew Spiden, Cemintel's General Manager, is extremely proud of his team's industry breakthrough.

"A lot of people in our business have spent years working on the development of this waterblocking process. Given the benefits, this technology represents a great leap forward for the fibre cement industry globally."

CeminSeal™ was developed as a result of ongoing feedback from contractors and builders in the market, Drew says.

"Joints and joint strength, whether external or internal, are raised again and again by our customers as areas of concern. What we have achieved with CeminSeal™ Wallboard is 95 percent stronger joint and compound adhesion, ensuring fewer callbacks and less overall risk."

Available for residential and commercial applications, CeminSeal™ Wallboard is more durable and easier to work with than existing wallboard products, says Cemintel™ Product Manager, Emma Young.



CeminSeal™ – Advantages

- Patented waterblock technology
- 95 per cent stronger joint and compound adhesion
- 100 per cent paint adhesion
- Fewer callbacks, less risk

The waterblocking technology makes the board more stable and easier to cut, while reducing sheet movement.

"CeminSeal™ is different in that it provides stronger joints, better compound adhesion and better paint absorption. This means an overall better substrate.

"It can be painted as normal and the waterblocking technology actually assists the paint adhesion, making it easier to be applied," Emma says.

Cemintel™ has extensively researched and tested the new CeminSeal™ range both independently in the market and internally.

The installation process of CeminSeal™ remains the same as for standard wallboard,

with the added bonus of better compound and paint adhesion providing a high quality finished wall.

Aimed at builders, contractors and specifiers, CeminSeal™ Wallboard is tinted yellow with a distinct face print to ensure easy identification. The new CeminSeal™ Wallboard will be available from late July 2009 through selected resellers. ■

i For more information contact Cemintel™ on 1300 CEMINTEL™ (1300 236 468) or visit www.cemintel.com.au.

news 2

Economic stimulus builds dividends

product update 4

MiTex™ gets the Gold

in focus 5

Gyprock™ extends environmental range

giveaway 8

Win a Holden SV6 ute!

Contact us

Getting more information on any of the products in *Club Gyprock* magazine is as easy as picking up the phone!

Club Gyprock 1300 306 556
Customer Service 131 744
DesignLink 1800 621 117

Or visit us online at www.gyprock.com.au

If you would like to receive future editions by email, please contact us at

kfoxall@csr.com.au or click on Club Gyprock News at www.gyprock.com.au

(click on 'newsletters' under 'resources').

Positive sentiment builds

There are signs that efforts to stimulate the Australian economy are having a beneficial impact in the building sector, writes HIA Chief Economist, Harley Dale.

It is encouraging that the news on the global economy has been slightly better in recent months. You would, however, describe the news as 'less bad' rather than 'good'.

Despite appearances that the rate of deterioration in global economic conditions may have bottomed, global economic output will still contract in 2009, the first time this has occurred in the post-World War Two era.

More stimulus

At home, global weakness really came home to roost at the end of last year with the Australian economy contracting by 0.5 per cent in the December 2008 quarter. Australia avoided a second consecutive quarter of contraction in the March quarter this year and this widely reported escape boosted confidence in the domestic economy. It is appearing increasingly unlikely that Australia went backwards in the June quarter either. Nevertheless, bare growth is the best we can expect for 2009 overall and that is not guaranteed.

Both the RBA and the Federal Government have undertaken unprecedented steps in an attempt to limit the economic slowdown in Australia—and there is mounting evidence that they are working, such as the GDP results mentioned above. Mortgage rates in Australia kept falling in early 2009 to reach their lowest level since the 1960s. And there have been two Federal Government stimulus packages as well as a further round of spending announced in the May Federal Budget. A significant amount of stimulus is directed to the housing industry.

Unemployment rates will climb throughout 2009 and 2010. HIA research conducted in late 2008 estimated a worst case scenario of unemployment peaking at around a nine per cent rate by the end of next year. It currently appears as though we were correct in labeling this outcome a 'worse case' even although we were relatively alone in that view at the time.

Building approvals recover

Building approvals recovered well in June after a sharp drop the previous month, but multi-unit approvals remained well down on mid-2008 levels. Unit approvals jumped by 28.1 per cent in June following a 39 per cent slump in May.

It is encouraging to see a recovery in the multi-unit sector in the month of June. A very small part of this result may be attributed to the Federal Government's Social Housing Initiative, with the majority of the boost from this program to emerge through 2009/10.

Multi-unit approvals fell by eight per cent in the June 2009 quarter and were down by 36 per cent compared to the June 2008 quarter. Federal programs such as the National Rental Affordability Scheme have a vital role to play in boosting the stock of new dwellings. It will be important to see evidence of renewed private investor interest in new residential property, something that remained lacking in the first half of 2009.

Detached house approvals continued their upward momentum, rising by 4.7 per cent in the month and nearly 12 per cent over the June quarter.

Home sales stronger

The number of new homes sold moved sideways in June, but were still up by 13 per cent for the first half of the year. This follows a 5.7 per cent drop in May that came after four positive months at the start of 2009.

While the modest June monthly result was weighed down by softer sales results in New South Wales and Queensland, the first half of 2009 clearly marked a healthy turnaround from the weak back half of 2008. The lift in new home sales over the first half of the year was driven by low mortgage rates and the first-homebuyer stimulus. Sales of detached homes rose by 18 per cent over the first half of 2009, signaling a pick-up in single dwelling starts in the back half of 2009.

A more positive picture for the detached dwelling sector was dimmed by weakness in the apartment sector where sales of units dropped by 20 per cent over the first half of 2009. The multi-unit sector continues to be plagued by investor uncertainty and restrictions on the availability of credit for development.

Renovations ease

Renovations investment peaked in the September 2008 quarter at a record annual value of \$31 billion. The trend in the volume of renovations investment has since been down. Reductions in interest rates and a return to growth in home values will counter employment fears to an extent, but the first half of 2009 did not yield much growth in this sector. Nevertheless, the renovations market held up reasonably well in the first quarter of 2009 and this sector should out-perform new building work done and new dwelling completions this year. ■

Private house sales

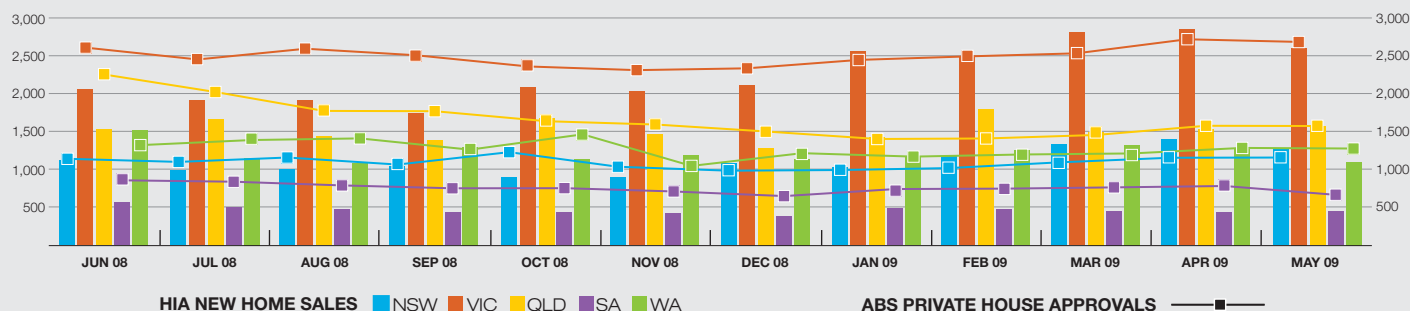

New and improved

Better presentation and provisions at Gyprock Trade™ centres will make it easier for trade customers to find what they are looking for.

Two Gyprock Trade™ centres (GTCs) in Melbourne have been modernised in an effort to better serve customers.

The GTC at Hoppers Crossing, in Melbourne's south-east, was originally commissioned in 1997. It closed for a brief period between 2006 and 2009, but was reopened in May this year.

The store has received a complete fit-out including new warehouse racking, showroom fixtures and fittings, as well as new signage and livery. In addition, the rear yard area was reworked and the centre was repainted.

The Bayswater GTC, located some 30kms east of Melbourne, is a relatively new store that opened early last year. It has already received the new look and standard provisions that are currently revitalising GTCs around the country. Internal and external livery has been brought up to the new benchmark, some shopfittings have been retrofitted and new showroom fixtures have been installed.

As is the case with all store upgrades, the product range has been reviewed and extended to present a more complete service that meets all customer needs.

The changes to both GTCs will mean a more user-friendly retail space that will make it easier for customers to find what they are looking for, according to Paddy Goodchild, General Manager—Trade Retail for CSR Lightweight Systems.

"The revamped stores are neater and arranged in a more orderly fashion. They will offer more products, in particular more Gyprock™ accessories and tools," he says.

Staff will also undergo additional training so that they are able to provide expert advice to customers and improved overall service, Paddy adds.

The changes are part of a push to improve the service offered by GTCs nationally. The retail strategy includes the upgrade of all existing GTCs, as well as the potential establishment of new stores in unserved areas where sufficient demand exists. ■



In service ... the new Bayswater Gyprock Trade™ centre

Safety on site

There has been a rationalisation of safety signs in Gyprock Trade™ outlets to highlight the most important aspects of safety that visitors need to be aware of.

The key messages include:

- Wear safety vests when entering the warehouse area;
- Children should be accompanied by an adult;
- No use of mobile phones in the warehouse area;
- Be aware of the hazards of forklifts and other materials handling equipment;
- A vehicle speed restriction of 5km per hour applies; and
- No smoking on site.

BCA revised

Plastering contractors should be aware of these recent changes to the Building Code of Australia.

The latest edition of the Building Code of Australia (BCA) came into effect on 1 May 2009. The most significant changes relating to plasterboard and fibre cement lining products are listed below. For a full list of amendments, refer to www.abcb.gov.au.

Fire protection

The provision to limit the spread of fire between adjacent houses of different heights has been clarified.

A NSW variation allowing openings in external walls of buildings to be located within 1m of a boundary for single-storey buildings and 1.5m for higher buildings has been incorporated into the main BCA.

The provision dealing with the protection of openings has been redrafted, making it clear that, sprinkler protection of void openings is not acceptable.

The changes also include clarification of which emergency generators and batteries

are to be fire separated, as well as clarification of the meaning of "window or other opening" for the purposes of vertical separation.

Sound provisions

The Queensland provisions for sound have been removed, bringing the State in line with the rest of the country (except Northern Territory). This means increased ratings between units in Class 2 & 3 and the introduction of the $R_w + C_{tr}$ rating scheme.

Referenced documents

The references to older editions of AS 1170 have been deleted. Design of low-rise masonry residential buildings under earthquake actions now refers to the newer 2007 edition.

The "Protocol for House Energy Rating Software" has been deleted after transition to the 2006.1 version.



As easy as BCA ... the revised Building Code of Australia

The views in this article are not necessarily those of the ABCB. Image produced with permission

For insulation materials, the transition period for AS/NZS 4859 allowing compliance with the standard prior to Amendment 1 has expired.

Corrosion protection

A new definition "breaking surf" has been included to assist in protection of metal components such as wall ties, steel frames and metal roofing that depend on the distance from breaking surf. Provisions dealing with corrosion protection of steel items built into masonry in houses have been revised.

Ceiling heights

New provisions for residential buildings have been included for ceiling heights of attics, rooms with sloping ceilings, and projections below the ceiling line. ■

Gold standard

CSR Gyprock products have outclassed the competition, being chosen for a new apartment block on the Gold Coast.

A nine-storey apartment complex, consisting of 36 units and several ground-level condominiums, is nearing completion on Chevron Island at Surfers Paradise after more than a year of planning and construction.

The project has used a range of CSR products including 26,000 square metres of Gyprock board, Bradford insulation and Cemintel. It is also clad externally with 5,000 square metres of MiTex™, an advanced texture coating system that has recently been developed by CSR. The project is the first in Queensland to use MiTex™.

Matt Mahoney, CSR Account Manager, says that while CSR was heavily involved in the early design stages of the project, a competitor secured the contract.

“However the builder, PBS Property Group, finally chose to go with CSR products because we had done so much work on the design; all our systems were specified in the plans,” says Matt. “MiTex™ was chosen because the builder preferred the look of it.”

Mark McMahon, the Plaster, Paint and Carpentry Contractor from Ausmac PPC who worked on the complex, describes MiTex™ as a “fantastic” product.

“It’s very easy to trowel,” he says.

“Blokes I’ve got applying it who have used a lot of competitor’s products just reckon that it’s a better a product to trowel.

Going up ... the apartment complex on Chevron Island



Key players ... (from left) Mark McMahon (Contractor), Matt Mahoney (CSR) and Peter Ritchie (Site Foreman) ↓



“It brings up a nice finish without any hassles. Its workable time is good, although obviously climate factor there—and the weather was warm when we were applying MiTex™ on Chevron Island,” he says.

“The builder’s happy and the client’s happy. They all like the finish we’ve produced. It’s come up really nice.” ■

i For more information about how CSR products including MiTex™, can improve your next project, call 1300 648 391.

The right angles

New heavy duty and slotted steel angles from Rondo are suitable for a wide range of applications.

Rondo has introduced a new range of heavy duty angles that suit both lightweight Autoclaved Aerated Concrete (AAC) panel systems and steel framing requirements for façade systems.

The new HB75 slotted angle will join the existing HB50 product used for head and base fixing for AAC panel systems.

The range of 75 x 75mm and 100 x 100mm nominal-sized 900 heavy duty angles are available in 0.75 and 1.15bmt steel thickness and can be used for a variety of purposes, such as strengthening internal corners of façade systems and for use with external stud framing.

Initially the range of new angles will be made to order and lead times may apply.

Due to their weight and subsequent OH&S handling requirements, Rondo will be supplying the slotted and heavy duty angles in lengths no longer than 2400mm.

The heavy duty angles will be manufactured from Bluescope Steel G2 Z275. ■

i For more information on the new heavy duty angles or any item in the Rondo product range visit www.rondo.com.au or contact one of the Technical Representatives at your state Rondo sales office on 1300 36 7663. Both products are also available at your local Gyprock Trade™ Centre.

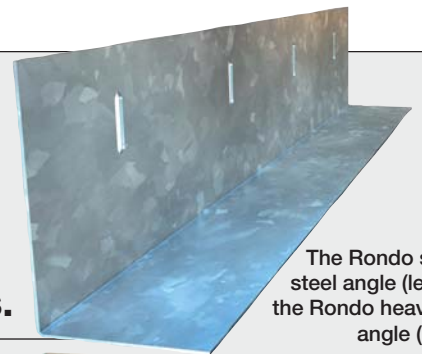

The Rondo slotted steel angle (left) and the Rondo heavy duty angle (below)

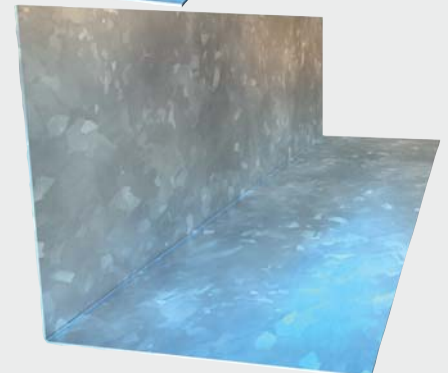

RONDO®

Green and growing

Gyprock™ has extended its range of environmentally friendly plasterboards to allow users to choose the right board for any sustainable project.

Gyprock™ continues to be at the forefront of green building practices, again driving industry standards higher with the expansion of its EC08™ plasterboard range.

Encompassing three environmentally friendly boards—EC08™ Partition, EC08™ Fire and EC08™ Impact—the extended range will give designers of green buildings the flexibility to specify different grade boards for specific applications. This can greatly reduce cost of achieving Green Star points, by allowing users to specify premium fire, acoustic and impact resistance boards only when they are needed.

“Recently, we have observed increasing interest from designers and specifiers who are eager to improve the sustainability of their developments,” says Gyprock™ Commercial Marketing Manager, Robert Ferrari. “This is an influential direction for the industry to be taking and is also positive news for the environment. At Gyprock™, we pride ourselves on keeping up with the needs of the marketplace and pioneering the way with latest building practices.”

Now there are three boards in the EC08™ range that carry GECA certification.

The original Gyprock EC08™, made with ReCore™ technology, was launched last year. It was the first Australian-made plasterboard to have been certified by Good Environmental Choice Australia (GECA). Now there are three boards in the EC08™ range that carry GECA certification and each can contribute to Green Star points based on Green Building Council Australia’s calculators.

Not only is Gyprock EC08™ produced with the highest level of recyclable content found in the Gyprock™ range of fire-grade and standard plasterboard, but it can also be recycled rather than adding to waste. Both were important factors in gaining GECA certification.

Across the board

Suitable for areas where fire resistance and acoustic properties are not required, the **EC08™ Partition** is an economical, non-fire rated board for general building requirements.

EC08™ Fire is the original EC08 board with a new name. It’s a fire-grade board with higher acoustic properties than standard plasterboard. Specifically,

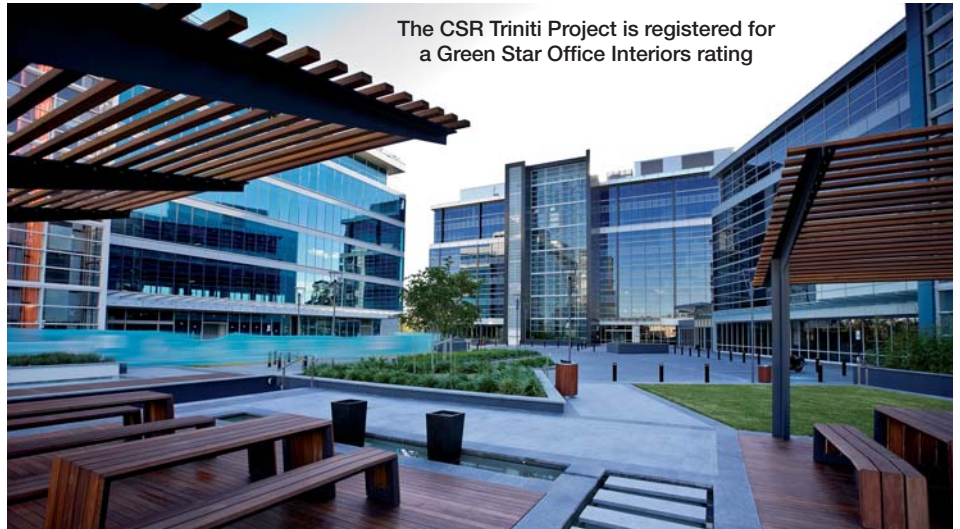

The CSR Triniti Project is registered for a Green Star Office Interiors rating

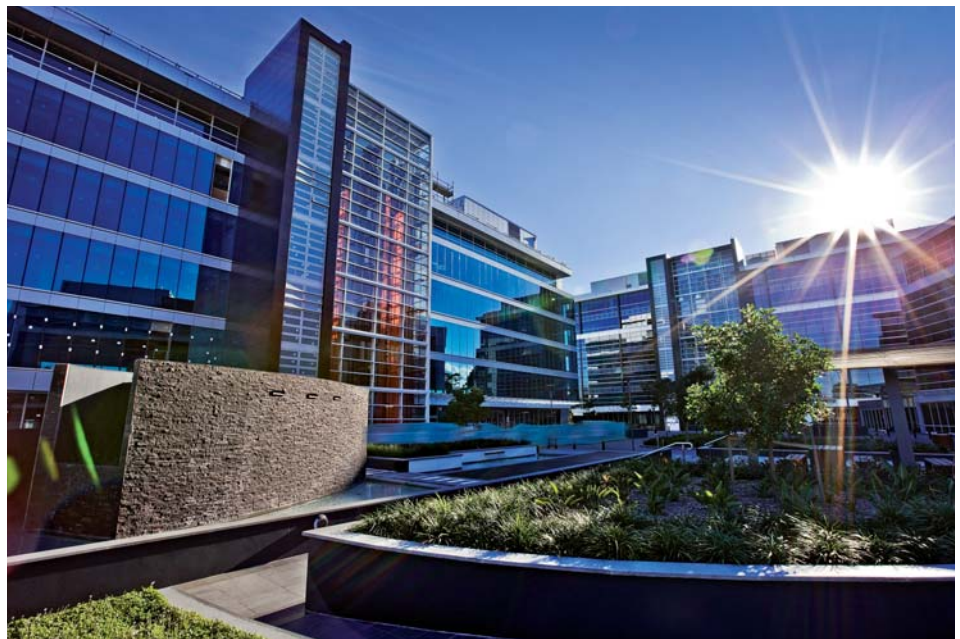

it has the equivalent fire and acoustic properties of 13mm Fyrchek which can be used in wall and ceiling systems. It is beneficial where fire resistance and improved acoustic performance are required.

EC08™ Impact is fire and acoustic rated with impact resistance for high-traffic areas such as education and health facilities. The level of recycled content in EC08™ Impact is greater than 20 per cent, which has been achieved by continued advances in Gyprock’s ReCore™ technology.

“We have noticed that as the green building market grows it is beginning to mirror the traditional commercial market’s requirements for specific plasterboards for

specific applications. Our extended range will ultimately help builders and designers to keep their Green Star cost premium below five per cent across a wider range of construction projects,” says Robert Ferrari.

Light green in colour, Gyprock EC08™ is available in 13mm thickness and in three dimensions: 1200 x 2700, 1200 x 3000 and 1200 x 3600mm. Installation of Gyprock EC08™ is practical and simple—in fact users can just follow standard plasterboard practice. ■

i For more information on the EC08™ range, contact Gyprock™ on 1300 306 556 or visit gyprock.com.au.

It's easy being green!

Contractors are choosing to promote EC08 to win Green Star projects.

EC08™, a new environmentally friendly plasterboard from Gyprock™, is winning praise from plastering contractors—and not just because it is good for the planet!

Users are also celebrating the product's acceptance on Green Star projects, ease of installation and excellent performance.

EC08™ was recently used for a development at the Melbourne Airport Business Park. The project will provide office and warehouse space for logistics company, Schenker Australia.

The project, which commenced in March and is scheduled for completion in June, used 470 sheets of EC08™. The product was chosen even though a competitor's board was included in the original specifications.

"They decided to go with EC08™ because of its competitive price and the better finish it offers," explains Sam Barrasso, Gyprock Account Manager on the project.

"The builder Australand is also very happy with the results," he says.

Andrew Hobday, Managing Director of Mainline Interiors, the plastering contractor who installed the EC08, adds that the product's environmentally friendly properties were also significant in selection by Australand. "It was a good product to work with," Andrew says, "and as easy to install as regular board."



The office and warehouse space was fitted with 1,500m² of EC08

The product has been designed in response to industry demand and can contribute to a project's Green Star points (through the Green Building Council of Australia's rating system). Not only is Gyprock EC08™ made using the highest level of recycled content of any product in the Gyprock™ range of fire-grade and

Users are also celebrating the product's acceptance on Green Star projects, ease of installation and excellent performance.

standard plasterboard, but it can also be recycled rather than generating more waste. These were both important factors in gaining the GECA certification.

Gyprock EC08™ is unique because it combines recycled content in the plasterboard's core and because it can also meet BCA fire and acoustic requirements.

Gyprock EC08™ is fully supported by a trained sales team and technical literature. ■

Environmentally sound

Gyprock EC08™ is the first Australian plasterboard to be given a 'green tick of approval' by Good Environmental Choice Australia (GECA) for its sustainable properties.

i For more information on the EC08™ range, please visit www.gyprock.com.au.

GYPROCK TRADE™ IS GOING GREEN! ARE YOU?

Why go green?

1. The beam of a green laser is 400% brighter and has more versatility, power, and intensity than a traditional red beam laser level.

2. Different colours of light, and laser beams, are determined by the size of those tiny waves, called the wavelength. A normal red laser has a wavelength of 650 nanometers versus a green laser that has even more energy in a wavelength of 532 nanometers. The smaller wavelength gives humans the ability, when indoors, to see the green light better and more accurately than a red light.



96393 - LS522 GREEN ELECTRONIC LASER

- Green laser beam
- Automatic self leveling laser
- Accuracy 3mm per 30m
- Huge working range
- Remote control
- Vertical and horizontal self leveling
- Variable speed and scanning functions
- Ideal for ceilings & internal walls



96392 - LS522 RED ELECTRONIC LASER

- Red laser beam
- Automatic self leveling laser
- Accuracy 3mm per 30m
- Huge working range 600m
- Remote control
- Vertical and horizontal self leveling
- Variable speed and scanning functions
- Tilt alarm function



96396 - LS606 MULTI LINE LASER

- The ultimate set out laser for internal walls & ceilings
- Projects 3 x vertical laser lines and 2 x horizontal
- Vertical lines form a 90 degree square for set out functions
- Detector supplied for outdoor use



96398 - CA601 ERGOEXPRESS LASER TAPE MEASURE

- Range of 0.2m - 50m
- Accuracy 2mm
- Area, volume and Pythagoras indirect height measuring mode
- Continuous Tape measure mode
- 5000 measurements per 9v battery
- Carry bag and calculator included



96397 - LP500 FIVE DOT LASER

- Self leveling 5 dot laser
- Plumb up and down, level and square
- Large self leveling range
- High accuracy, 2mm @10m
- Out of level laser flash warning

Perfect perforation

A perforated metal ceiling tile supplied by CSR Fricker has proved to be the right choice for a 30,000-metre office development in Homebush, NSW.

CSR Fricker has supplied a large commercial development in Sydney with a ceiling that not only looks great but also meets the project's unique technical requirements.

Known as 'Tabitha', the development is owned by Colonial First State and was built by property giant Bovis Lend Lease for its tenant the Commonwealth Bank. The massive site, located at Homebush in NSW, covers 30,000 square metres of net lettable space.

Fricker worked with Bovis Lend Lease's design team to design and supply a metal ceiling consisting of several different size perforations and colours. It enhanced the aesthetics of the interior while also accommodating a chilled-beam air conditioning system, according to George Werner, Fricker Ceilings Business Development Manager who worked directly on the project.

Both are very pleased with the look and performance of the various Fricker ceiling systems.

The team developed a perforated metal pan ceiling system where tiles sit flush within an aluminium grid to eradicate shadowing and disruptions. "The tiles were specially perforated to allow for the correct flow of air to and from the chilled beams," explains George.

"The chilled-beam ceilings and metal tiles manufactured from steel containing 25 percent recycled content helped with Bovis Lend Lease's environmental requirements," he adds.

The project was completed late in 2007. Lend Lease and the contractor are both very pleased with the look and performance of the various Fricker ceiling systems.

CSR Fricker Ceiling Systems designs and supplies complete ceiling solutions, including aluminium grid, metal and mineral fibre tiles, integrated pelmets and diffusers, and light fittings for all types of commercial buildings, from new CBD office towers and refurbishments to campus style business parks. ■



Smart and good looking ... the Fricker two-way easy access ceiling system was tailored to meet the project's chilled beam requirements

Up in the air ... the perforated tiles allow the correct flow of air through the ceiling system to interact with the chilled beams →



Superb solutions

Are you familiar with CSR Fricker's wide range of ceiling options?

CSR Fricker offers a diverse range of suspended ceiling solutions that are tailored to suit any development, whether it is commercial buildings, education or healthcare facilities, or retail or industrial developments.

Fricker offers both steel and aluminum grid systems in both standard and custom-size modules to suit each individual project.

Fricker has developed an extensive range of tiles to provide the right ceiling solution for the right environment. CSR Fricker USG Mineral Fibre varies from commodity to premium-end tiles that are high in recycled content and have great acoustic properties.

Manufactured by SAS International, Fricker's metal pan tiles are high quality, ensuring consistency, durability, and a low level of maintenance.

Ecophon glasswool ceiling options are premium products offering superior acoustic performance. They use eight different edge details to provide a wide variety of designs meeting first-class

acoustic and aesthetic requirements. Fricker can assist with a range of edge details and finishes to suit individual project performance requirements and visual preferences.

To add that finishing touch to an integrated ceiling system, Fricker can design and supply perimeter details. Various standard options are available but a custom solution can be designed to make your ceiling stand out.

Fricker also offers design and supply of energy-efficient lighting that can be integrated seamlessly with the company's suspended ceilings. T5 Troffer lights, based on cutting edge technology with Dali dimmable systems and slot punches for supply or return-air handling, are available in any size to suit the appropriate grid module.

To complement, or in some cases substitute for, your acoustic ceiling, Ecophon wall panels are also available. Not only do they improve sound absorption but they are also obtainable in different colours and finishes. ■



For more information about how CSR Fricker Ceiling Systems can enhance your next project, please call 1300 FRICKER (1300 374 253).

WIN ME



CEMINSEAL™ WALLBOARD

WATERBLOCK TECHNOLOGY

- CSR's new CeminSeal™ Wallboard prevents water penetrating into the sheet.
- 95% stronger joint and compound adhesion.
- 100% paint adhesion.
- Fewer callbacks, less risk.

www.cemintel.com.au

CSR01CG

WIN A HOLDEN SV6 UTE



Holden.
Go better.

- 195kw 3.6 Litre Alloytec V6 Engine
- Electronic Stability Control
- Sports Body Kit
- 18" Alloy Wheels (4)

Win a brand new Holden SV6 Ute with CSR CeminSeal™. Simply make a CeminSeal™ purchase and complete the entry form to be entered into the competition. The competition runs from 01/09/09 - 18/12/09.

For full terms and conditions go to www.cemintel.com.au

cemintel™
fibre cement systems

CSR